



Welcome to the July 2013 newsletter from the Love's Farm Community Association.

Northern access - petition

By Grant Morrison

The entrance to Love's Farm via the bridge over the railway line at the northern end of the development is intended to remain closed to all vehicles except buses and emergency services. However, a number of Loves Farm residents have expressed an interest in opening up the Northern access to cars.



You can help take action by signing a petition online through our website. You have until 15th September to sign the petition, after which it will be submitted to Cambridgeshire County Council for their consideration.

Opening the access to all traffic will provide benefits to all residents - wherever you live on the development:

- Reduced traffic flows
- Reduced congestion on Cambridge Road/Cambridge Street by providing good alternative routes to St Neots town car parks, etc.
- Reduced travelling by up to 3.5 miles on return journeys to Huntingdon and other destinations north with little or no increase in traffic on Priory Hill.

<http://www.ourlovesfarm.co.uk/northern-access>

Award for Phyllis - SMART

Phyllis Hooper, our SMART day co-ordinator has recently won a 'Community Champion Award' from bpha. Part of Phyllis' nomination -



"Phyllis is a one woman environmental pressure group. She organises the SMART days; publicises them; liaises with the local authority for litter picking equipment and removal of the waste collected. Working with Phyllis we hope to be able to encourage the children at the local primary school to be the 'litter spotter' for Love's Farm and promote to them the care for their local environment and pride in where they live."

Our new retail centre

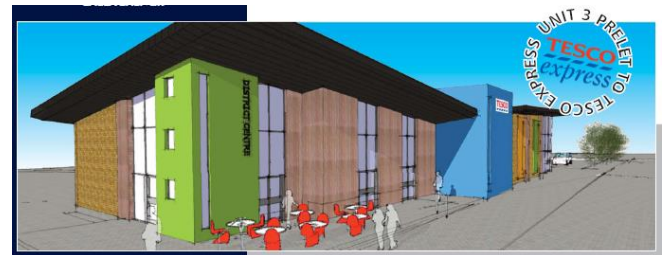

Our new retail centre on Loves Farm is taking shape with 5 units, including Tesco Express, Barnardo's and 43 car parking spaces. Four units are up for sale through Bidwells.

Our new e-newsletter

Are you signed up to our Loves Farm website? If so, you will receive our new electronic newsletter in the months between the paper versions.

<http://www.ourlovesfarm.co.uk/>

SMART kids and others

By phyllis.hooper@btinternet.com

Recently we held our first SMART evening and for once the weather was kind. Thank you everyone that joined us. Announcing that they thought them “cool”, two of the boys took grabbers, and a supply of bags home! If you see them picking up litter give them the thumbs up and also let me know!



Now that litter on Loves Farm is much less of a problem than it was, SMART is looking for other ways of helping to improve our environment. If you let me know what bothers you, we can consider how best to go about things.

Another suggestion put forward by our Community Association is the possibility of SMART being able to help older or disabled residents with concerns they may have about their surroundings. Again, let me know.

The next SMART is on the evening of
Wednesday 24th July.

New play area

The new 'Indian Camp' themed play area by Aunties Wood is currently being assembled and is due to open in the next few weeks. We will host a 'grand opening' on 18 July, from 15:30, everyone welcome.



Our monthly quiz

Join our popular Loves Farm Quiz Night at the Football Club, last Wednesday of every month, 19:30. You don't have to have a ready formed team, just come along and join a team. Bring your own drinks and snacks.

Let's discuss

What's being discussed on the Loves Farm discussion forums this month?

<http://www.ourlovesfarm.co.uk/Forums>

- Odd jobs
- School reviews
- Financial Advisor
- Service charges
- Local paper
- Electric strimmer for sale

Out and about

We feature 3 places each month, all within an hour's drive of Loves Farm. This month highlights include Brampton Wood, Priory Park, Bedford and Wandlebury Park



Upcoming events

Play area grand opening – Aunties Wood play area. 18 July, 15:30.

Summer chocolate bingo – St Neots Football Club, 24 July

Summer shopping evening – St Neots Football Club, 8 August, 19:00

Loves Farm Community Association meetings – 22 July and 20 August, 19:30

Exercise classes

St Neots Football Club has two exercise classes that may be of interest.

- Zumba – Wednesday 10-11am
- Pilates – Wednesdays, 11-12pm

Keep in touch

There are multiple ways to keep in touch with neighbours in Love's Farm, through our [website](#) or Facebook (Loves Farm Community Association).

Also, we always like to hear [feedback](#) on our newsletter.